

MOLE TAZZA CONICA PER AFFILATURA BULINI

Mole elettrodepositate in Diamante o CBN a tazza conica per affilatura bulini.

La grana D151 è utilizzata per sgrossatura. La grana D76 per semifinitura e finitura.

12C9

CONICAL CUP WHEELS FOR GRAVER SHARPENING

Electroplated Diamond wheels in Diamond or CBN for sharpening conical cup gravers. Grit size D151 is used for roughing. Grit size D76 for semi-finishing and finishing.

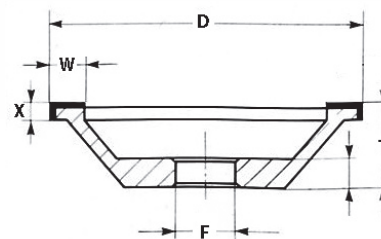

DIMENSIONI / DIMENSIONS*					DIAMANTE / DIAMOND			CBN (Borazon®)		
DIA Ø D	FORO/HOLE Ø	T	FASCIA/BAND		D151	D76	STOCK	B151	B76	STOCK
			W	X						
mm										
100	20	30	10	3	12C9-ED100	12C9-ED100F	★	12C9-EB099	12C9-EB099F	★

*N.B. Fori diversi sono eseguibili su richiesta. / Different hole on request..